

246-000022

Minifix Screw

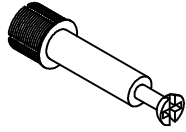

X26

A

Minifix

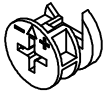

X26

B

Wood Minifix

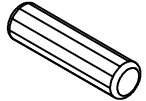

X7

C

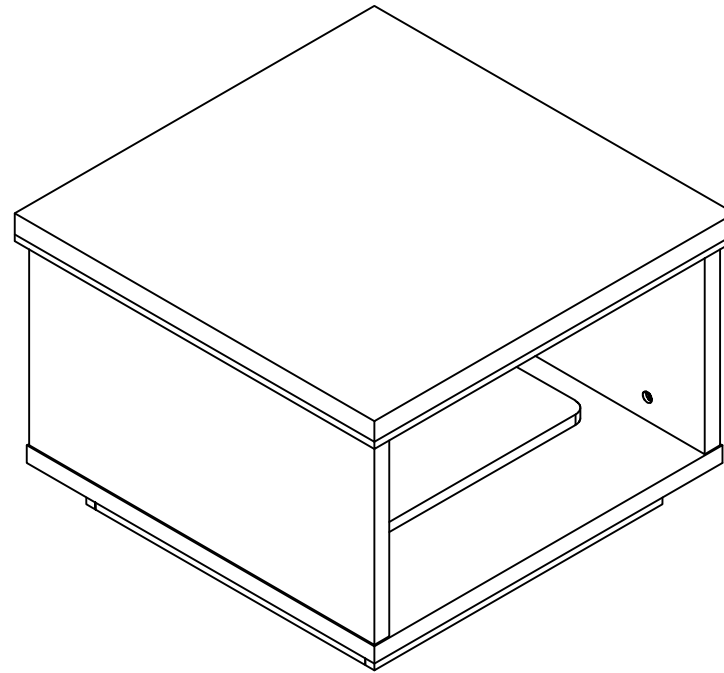

(600X600X420)

STEP:1

To fix the side panel(1)and shelf panel (2)

X2

A

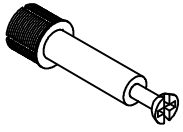

X2

B

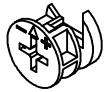

X1

C

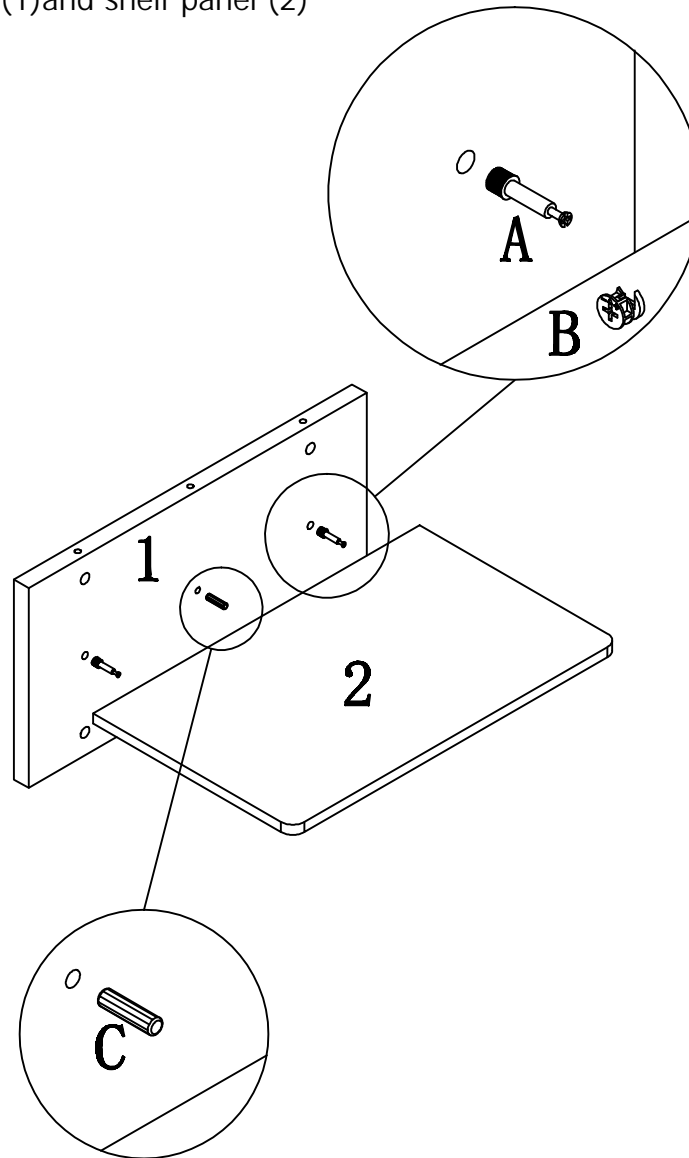
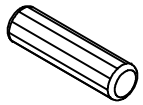

STEP:2

To fix the panel(3)

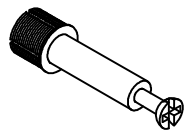

X2

A

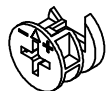

X2

B

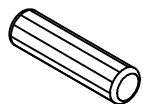

X1

C

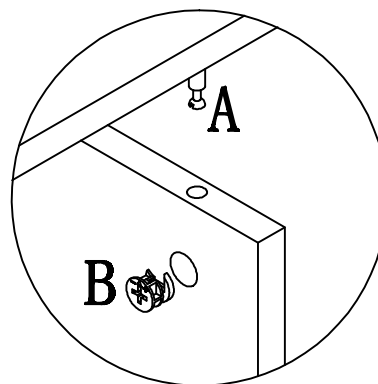
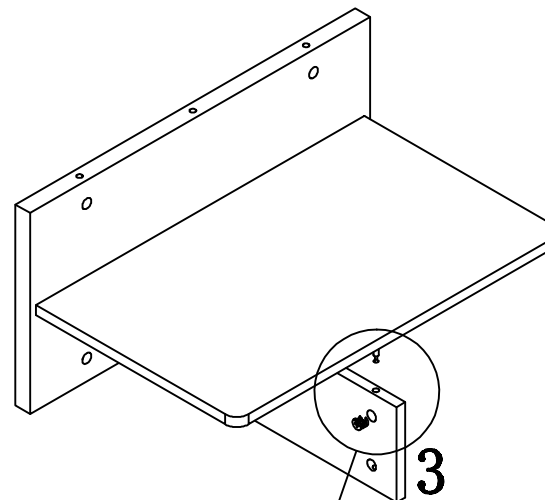

STEP:3

To fix the bottom panel(4)

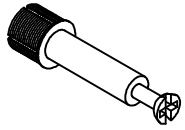

X4

A



X4

B

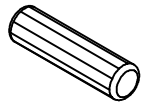

X2

C

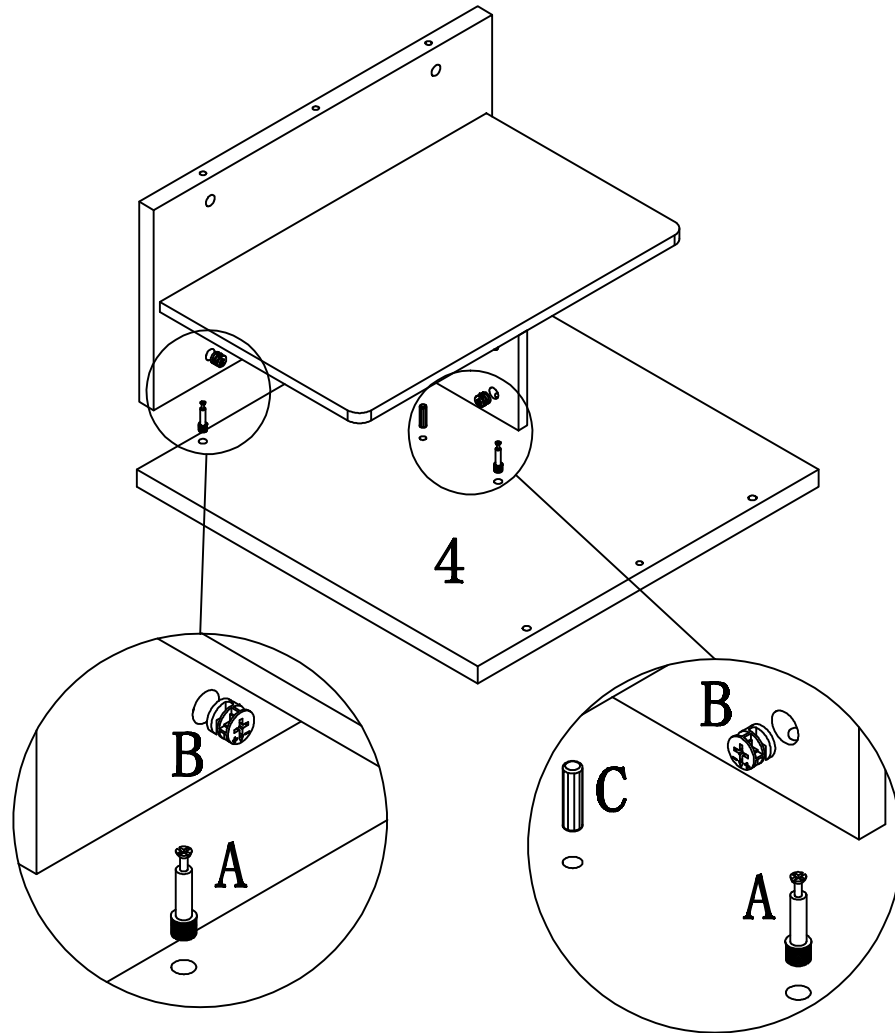

STEP:4

To fix the side panel (5) on bottom panel(4)

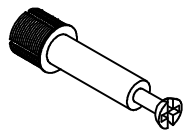

X2

A

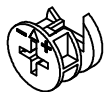

X2

B

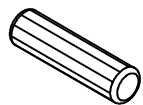

X1

C

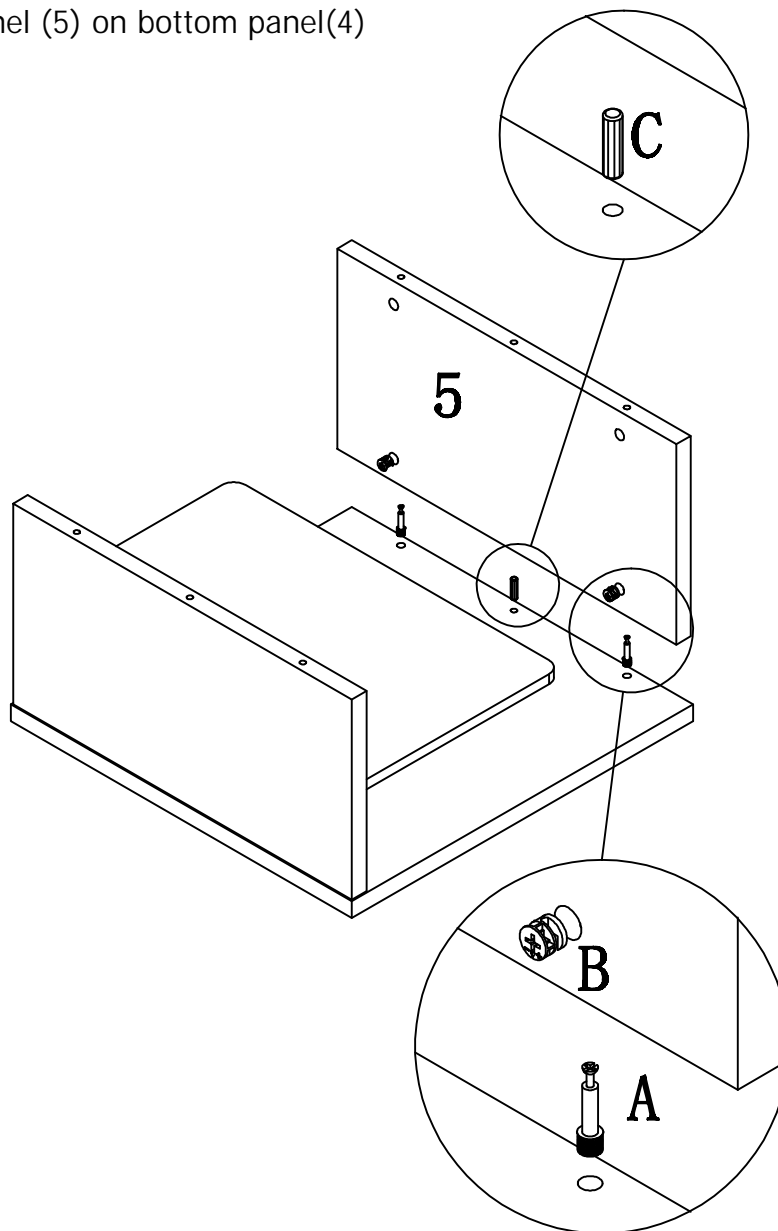

STEP:5

To fix the top panel (6) on both side panel

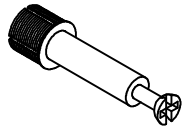

X4

A

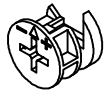

X4

B

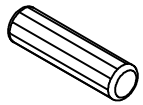

X2

C

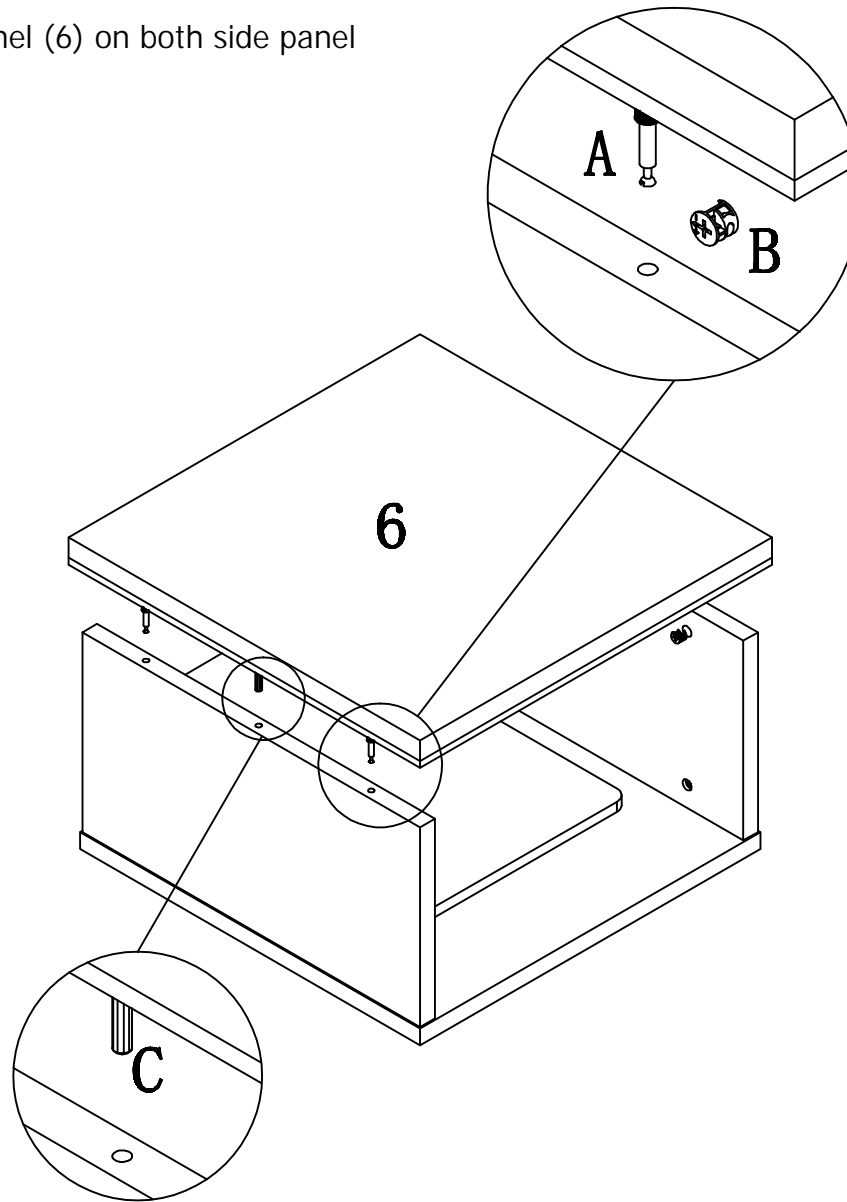

STEP:6

To fix the foot stand support panel(7 & 8)

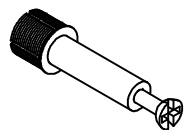

X8

A



X8

B

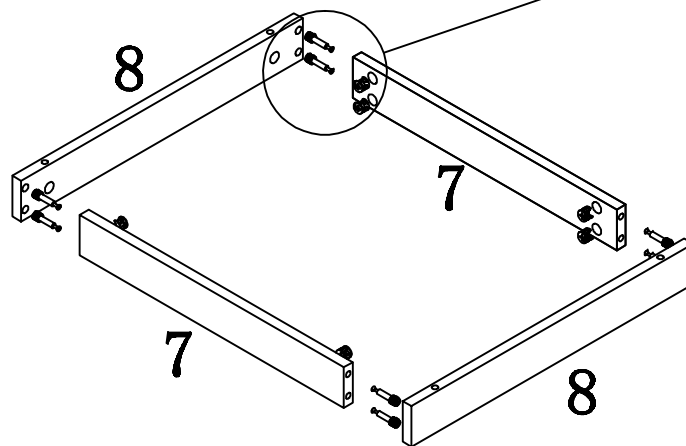
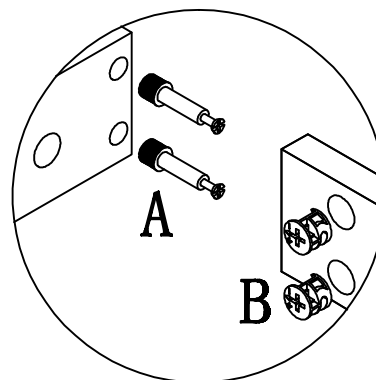

STEP:7

To fix bottom panel on foot stand support

FINISH

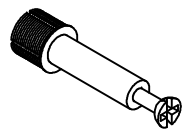

X4

A



X4

B

